

# SX723 Portable pH/Conductivity Meter

## User Manual



**APER A INSTRUMENTS, LLC**

[aperainst.com](http://aperainst.com)

## Table of Contents

<b>1</b>	<b>Brief Instruction</b>	<b>3</b>
<b>2</b>	<b>Technical Specifications</b>	<b>5</b>
2.1	pH	5
2.2	mV	5
2.3	Conductivity	5
2.4	Other Technical Parameters	5
2.5	Working Condition	6
<b>3</b>	<b>About the Meter</b>	<b>6</b>
3.1	Screen Display	6
3.2	Keypad	6
3.3	Data Log, Recall and Delete	7
<b>4</b>	<b>What's in the Kit</b>	<b>8</b>
<b>5</b>	<b>Preparation</b>	<b>9</b>
<b>6</b>	<b>pH Measurement</b>	<b>10</b>
6.1	pH Electrode	10
6.2	pH Calibration	10
6.3	Notes about pH Calibration	11
6.4	Sample Test	12
6.5	Recommended pH Electrodes for Different Applications	12
6.6	Parameter Setting	13
6.7	Cleaning pH Electrode	15
6.8	The Self-diagnose Information	15
6.9	Notes about pH	16
<b>7</b>	<b>Conductivity Measurement</b>	<b>16</b>
7.1	Preparation	16
7.2	Conductivity Calibration:	17
7.3	Sample Test	17
7.4	Conductivity Electrode's Maintenance	17
7.5	Notes about Conductivity Calibration	18
7.6	Parameter Setting:	18
7.7	Temperature compensation coefficient	20
7.8	Notes about conductivity parameter setting	21
<b>8</b>	<b>Limited Warranty</b>	<b>23</b>

*Scan the QR code below to watch the tutorial video on Youtube.*

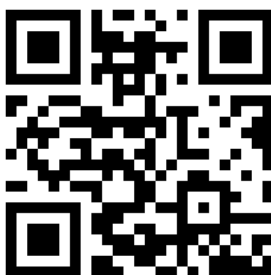

---

---

## **1 Brief Instruction**

---

---

Thank you for choosing Apera Instruments SX723 Portable pH/conductivity Meter (will be called “the meter” in short in the following content). Before using the meter, please read this instruction manual carefully to help you properly use and maintain it.

The meter can measure the parameters of pH, conductivity, TDS, salinity, resistivity, and temperature of water solutions with high accuracy. It is suitable for various applications in different industries e.g., water treatment, aquaculture, horticulture, pools, beverage making, mining, power plants, environmental monitoring, etc., especially ideal for in-field use.

The meter has the following features:

- 1.1. Built-in microprocessor chip with the intelligent functions of auto. calibration, auto. temperature compensation, auto. salinity compensation, manual barometric pressure compensation, data storage, function settings, auto. power off, and low voltage display etc.
- 1.2. Adopts digital filter technology to intelligently improve meter’s response speed and accuracy. The smiley face icon will appear when the reading is stable.
- 1.3. Pure water modes available for pH and conductivity, significantly increasing the accuracy.
- 1.4 Unique 1-point conductivity calibration covering a wide range of 0 to 200mS, easy to use.
- 1.5. Meter’s LCD screen has clear and bright backlit display.
- 1.6. Built-tough. IP57 waterproof and dust-proof.

## ⚠ CAUTION



Explosion hazard. Incorrect battery installation can cause the release of explosive gases. Be sure that the batteries are of the same approved chemical type and are inserted in the correct orientation. Do not mix new and used batteries.

## ⚠ WARNING



Fire hazard. Battery substitution is not permitted. Use only alkaline batteries.

## How to Replace the Batteries

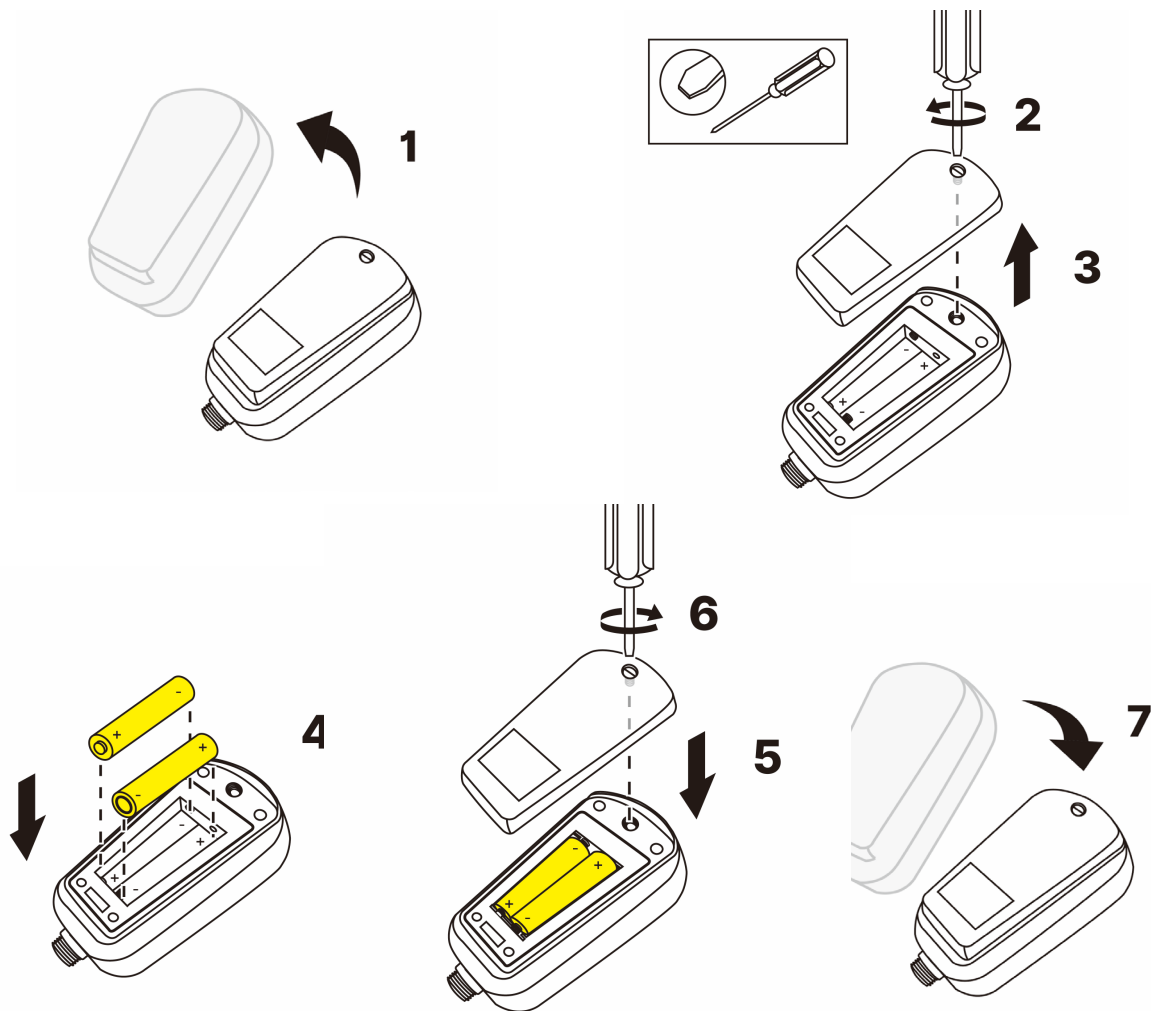

## ⚠ CAUTION



Chemical exposure hazard. Obey laboratory safety procedures and wear all of the personal protective equipment appropriate to the chemicals that are handled. Refer to the current safety data sheets (MSDS/SDS) for safety protocols by scanning the QR code on the right.



---

---

## 2 Technical Specifications

---

---

### 2.1 pH

Measurement range	(-2.00 to 19.99) pH
Resolution	0.1/0.01 pH
Accuracy	Meter: $\pm 0.01$ pH; Overall: $\pm 0.02$ pH
Input current	$\leq 2 \times 10^{-12}$ A
Input impedance	$\geq 1 \times 10^{12}$ $\Omega$
Stability	$\pm 0.01$ pH/3h
Temp. compensation range	(0 to 100) °C (automatic)

### 2.2 mV

Measurement range (mV/ORP/EH)	-1999 mV to 0 to 1999mV
Resolution	1mV
Accuracy	Meter: $\pm 0.1\%$ FS, Overall: $\pm 15$ mV

### 2.3 Conductivity

Measurement range	Conductivity: (0.00 to 19.99) $\mu$ S/cm (20.0 to 199.9) $\mu$ S/cm (200 to 1999) $\mu$ S/cm (2.00 to 19.99) mS/cm (20.0 to 199.9) mS/cm TDS: (0 to 100) g/L; Salinity : (0 to 100) ppt Resistivity: (0 to 100) M $\Omega$ ·cm
Resolution	0.01/0.1/1 $\mu$ S/cm 0.01/0.1 mS/cm
Accuracy	Meter: $\pm 1.0\%$ F.S, Overall: $\pm 1.5\%$ F.S
Temp. compensation range	(0 to 50) °C (automatic)
Electrode constant	0.1 / 1 / 10 cm <sup>-1</sup>
Reference temperature	25°C, 20°C, and 18°C

### 2.4 Other Technical Parameters

Data storage	400 sets
Data content	Serial number, measurement value, measurement unit, and temperature
Power Supply	Two AA alkaline batteries (1.5V x2)
Dimensions and weight	Meter: (65×120×31) mm/180g Complete Kit: (255 x 210x 50) mm/1760g

## 2.5 Working Condition

Working environment temperature	5 to 50°C
Working humidity	≤85%
IP rating	IP57 water-resistant

## 3 About the Meter

### 3.1 Screen Display

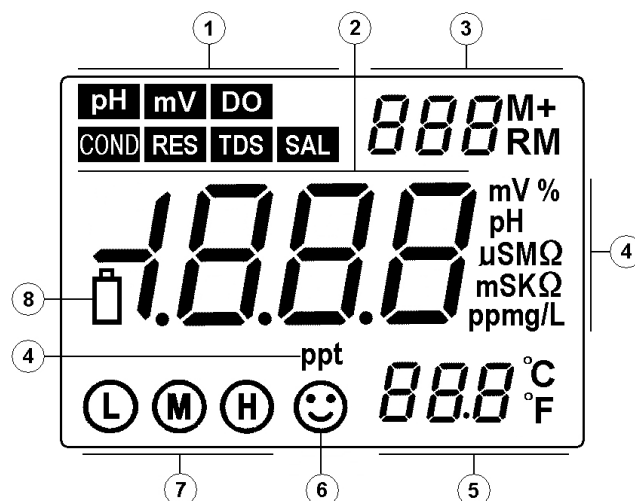



- ① — Parameter icon    ② — Measurement value
- ③ — Serial number and icon as measurement to be saved and recalled and indication icon for special states.
- M+** — measurement value to be saved; **RM** — Saved data to be recalled;
- ④ — Measurement unit    ⑤ — Temperature measurement value and unit
- ⑥ — Measurement stabilization icon    ⑦ — Electrode calibration indication icon
- ⑧ — Indication icon of low battery power; appears when the voltage is less than 2.6V, calling attention to replace the batteries.

### 3.2 Keypad

The meter has 5 operation keys in total.

Short press: press time <1 seconds; Long press: press time >2 seconds

3.2.1.  — Short press to power on or off.

3.2.2.  — Calibration key

(a) When in measurement mode, short press to enter calibration mode.

(b) When in parameter setting mode, short press to make changes.

3.2.3.  — Function key

(a) In **pH** measurement mode, short press (<1.5s) to switch between **pH** and **mV** . Long press to enter parameter setting (P1, P2, P3...)

(b) In other measurement mode, short press this key to enter the parameter setting mode (P1, P2, P3...)

3.2.4.  — Backlight and confirmation key

(a) In measurement mode, short press to turn on or off the backlight.

(b) In calibration mode or the parameter setting, press this key to make confirmation, and return to measurement mode.

(c) When in **pH** mode, hold this key to change pH resolution: 0.01→0.1 pH in turn. Release key when you confirm the selection.

(d) When in **COND** measurement mode, hold this key to change parameter in turn:

**TDS** (Total Dissolved Solids) → **SAL** (salinity) → **RES** (resistivity)→ **COND** (conductivity). Release the key when you confirm the selection.



3.2.5.  — The key for data saving and recalling

(a) When in measurement mode, short press to save the measurement data; Long press to recall the saved data.

(b) When in parameter setting mode, press the key to make changes.



### 3.3 Data Log, Recall and Delete

3.3.1. Save the measurement:

In measurement mode, when the reading is stable and  stays on screen, short press  to save the measurement data. **M+** icon and the data serial number will show up on the upper right corner. The meter can store up to 400 sets of data.

3.3.2. Recall saved data:

(a) In measurement mode, long press  , the meter will recall the last saved data and the serial number. **RM** icon will appear in the upper right corner of the screen.

Short press  again, the meter will recall all the data in turn, hold  or  to quickly review the data.

(b) In data recalling mode (**RM** and serial number in the upper right corner), short press  to return to measurement mode.

### 3.3.3. Delete data:

In data recalling mode, hold  for 5 seconds, **CLR** will show up for 2 seconds, meaning that all the saved data have been eliminated. Then the meter will return to measurement mode.

---



---

## 4 What's in the Kit

---



---

SX723 pH/Conductivity meter *1	201T-S pH/temp. electrode *1
2301T-S conductivity/temp. electrode *1	Spare AA batteries *2
1413 $\mu$ S/cm conductivity calibration solutions (50mL) *1 bottle	Silicone boot *1
pH buffer solutions (pH4.00, pH7.00, pH10.01, 50ml bottle/each)	Screw driver *1
User manual *1	Carrying case *1

---

---

## 5 Preparation

---

---

What you need in addition to what's in the kit:

Pure water (distilled or deionized water) for rinsing off the electrode.

### Connect the Electrode

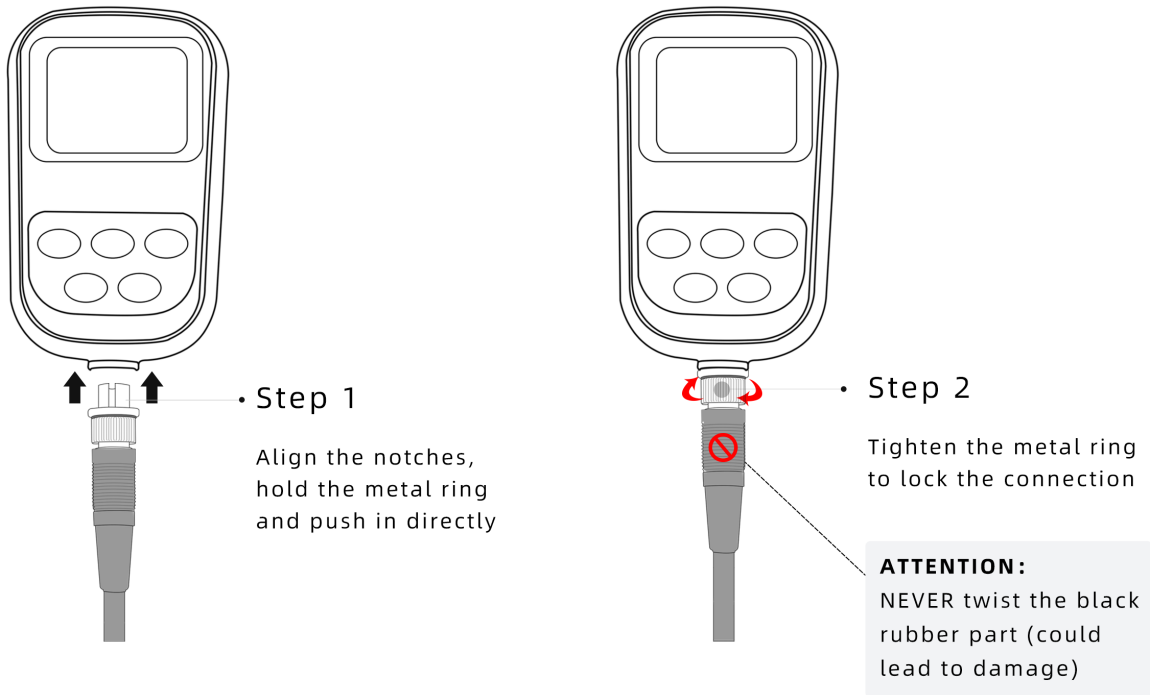

### Disconnect the Electrode

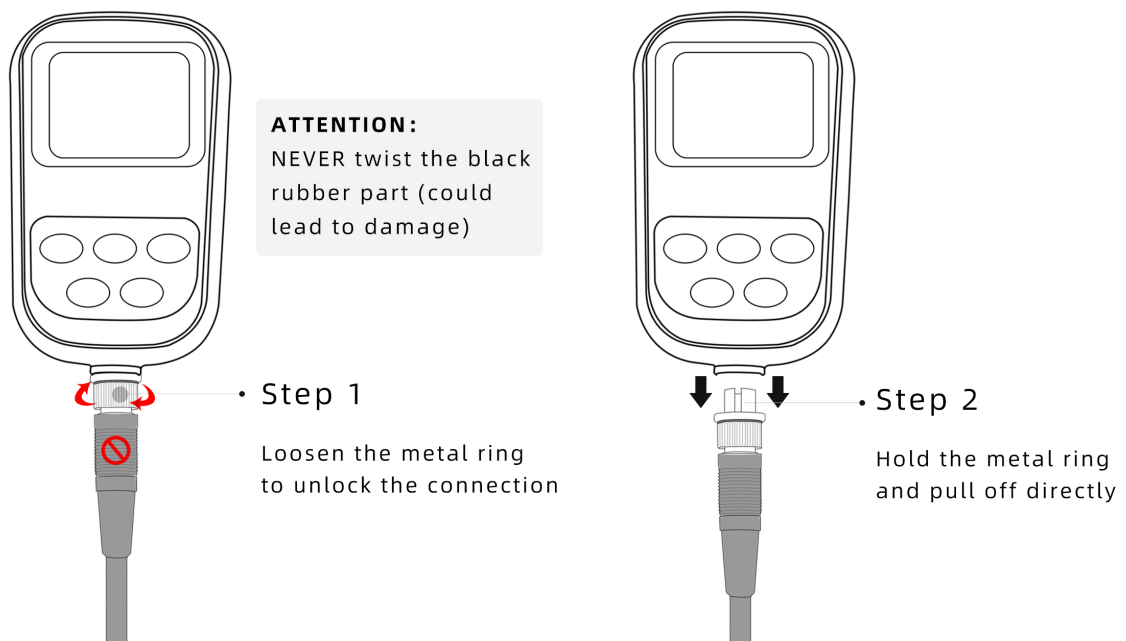

---

---

## 6 pH Measurement

---

---

Short press  to turn on the meter. Connect 201T-S pH electrode to the meter (See Section 5 for connection tutorial). The meter will automatically enter pH measurement mode.

### 6.1 pH Electrode

The meter comes with the 201T-S 3-in-1 combination electrode with a built-in temperature sensor, which enables automatic temperature compensation. **This electrode is only suitable for general water solutions' pH testing.** Please refer to Section 6.5 for ideal pH electrodes to use for other applications. A 3M KCL storage bottle comes with the electrode, which is for storing the electrode when not in use to keep the sensitivity of the probe.

#### 6.1.1 Technical Specifications of the 201T-F pH Electrode

Measurement Range: 0 - 14 pH, 0 - 80°C (32 – 176°F) ; Junction: Single Ceramic

Reference Electrode: Ag/AgCl Connector: 8-pin



Size: ø12\*160 mm; cable length: 1 meter



Temperature unit: 30K Thermistor

#### 6.1.2 Use the Electrode

Screw off the KCL storage bottle, and put it aside (do not dump or spill the KCL solution). Rinse the electrode with distilled or deionized water. Shake off excess water or blot-dry with clean tissue or kimwipe. Stir the electrode for a few seconds after it's dipped into the test solution and then hold it still. Wait for the reading to get fully stabilized (  appears and stays) and then take the measurement. When the test is finished, place the electrode in the storage bottle and tighten the cap to keep the sensitivity of the pH sensor.

### 6.2 pH Calibration

6.2.1 After powering on the meter, short press  to enter calibration mode,  flickers on LCD, indicating the meter enters the first point calibration.

6.2.2 Rinse off the pH electrode in pure water and remove excess water, then insert it into the pH7.00 buffer solution, make a quick stir and then hold it still. When the reading is stabilized and  stays on screen, short press  again to finish the 1<sup>st</sup> point calibration. “7.00 pH” will start flickering and a flickering  will show up, indicating the 1<sup>st</sup> point calibration has been finished and the meter is entering

the 2<sup>nd</sup> point calibration.

6.2.3. Rinse off the pH electrode in pure water and remove excess water, then insert it into the pH4.00 buffer solution, make a quick stir and then hold it still. When the reading is stabilized and ☺ stays on screen, short press **CAL** again to finish the 2<sup>nd</sup> point calibration. “4.00 pH” will start flickering and a flickering **[3]** will show up, indicating the 2<sup>nd</sup> point calibration has been finished and the meter is entering the 3<sup>rd</sup> point calibration.

6.2.4. Rinse off the pH electrode in pure water and remove excess water, then insert it into the pH10.01 buffer solution, make a quick stir and then hold it still. When the reading is stabilized and ☺ stays on screen, short press **CAL** again to finish the 3<sup>rd</sup> point calibration. “10.01 pH” will start flickering and then the meter will return to measurement mode.

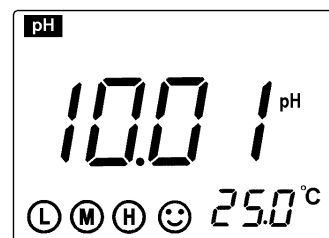

Picture (4-1)

**L** **M** **H** will show up at the bottom left (see picture 4-1), indicating all three points of calibration are finished.

### 6.3 Notes about pH Calibration

- 1) Keeping the freshness and cleanliness of calibration buffers is essential for accurate pH measurement. The small bottles of pH buffers come with the meter should be replaced within 3 months after opening. The new buffer solutions should be made by a legitimate lab supply manufacturer. Avoid sunlight and air contact when the buffers are not being used, and store at room temperature.
- 2) This meter can adopt random 1-point, 2-point or 3-point automatic calibration. During calibration, short press **ENTER** to return to measurement mode. When the measurement accuracy is  $\leq \pm 0.1$  pH, choose a buffer that's close to the estimated measurement range and perform 1-point calibration would be good. Choose pH4.00 and pH7.00 to calibrate if the measurement range is within the acidity range (<pH 7) and choose pH7.00 and pH10.01 to calibrate if just within the alkalinity range (>pH 7).
- 3) Choose 3-point calibration to achieve a more accurate measurement if the measurement range is wide, or if the electrode has not been used for long. When connecting a new pH electrode, it must be calibrated at 3 points.
- 4) The frequency that you need to calibrate your meter depends on the tested samples, condition of electrodes, and the requirement of the accuracy. For High-Accuracy measurements ( $\leq \pm 0.02$  pH), the

meter should be calibrated before test every time; For ordinary-accuracy measurements ( $\geq \pm 0.1\text{pH}$ ), once calibrated, the meter can be used for about a week or longer. In the following cases, the meter must be re-calibrated:

- The electrode hasn't been used for a long time or a new electrode is connected.
- After measuring strong acid ( $\text{pH} < 2$ ) or strong base ( $\text{pH} > 12$ ) solutions.
- After measuring fluoride-containing solution and strong organic solution.
- There is a significant temperature difference between the test sample and the buffer solution.

## 6.4 Sample Test

Power on the meter. Connect the pH electrode and the meter goes to pH measurement mode automatically. Screw off the KCL storage bottle. Rinse the electrode with pure water. Shake off excess water or blot-dry with clean tissue or kimwipe. Stir the electrode for a few seconds after it's dipped into the sample solution and then hold it still. Wait for the reading to get fully stabilized (😊 appears and stays). Then save the measurement by pressing .

According to the pH isothermal measurement principle, the closer the test sample's temperature is to the calibration solution's, the higher the accuracy of the measurement. This principle is recommended to follow for the best result. For example, if you must test at 150°F, we recommend warming up the calibration solutions to the same temperature before performing calibration in order to get the most accurate readings.

## 6.5 Recommended pH Electrodes for Different Applications

Application	Ideal Apera pH Electrode Model
General water solutions	201T-S
Beverage, beer, wine	LabSen 335
Low ionic strength solutions (RO water, distilled water, deionized water...)	LabSen 805
High-Temperature solutions	LabSen 865
Viscous liquid e.g. cosmetics, skin care products, paints, coatings, glues, resin, etc	LabSen855
High salinity solutions	LabSen 845

Complex and caustic solutions (e.g. electroplating)	LabSen 865
Raw meat, meat products, foods, fruits, cheese, vegetables	LabSen 765
Micro sample testing	LabSen 246-5
Strong acid solutions, HF containing solutions (HF concentration<1%)	LabSen 835
Strong alkaline solutions	LabSen 845
Wastewater, emulsions, suspensions, slurries	LabSen 335

\* Visit [aperainst.com/product/electrode/labsen](http://aperainst.com/product/electrode/labsen) or contact us at [info@aperainst.com](mailto:info@aperainst.com) for more details.

## 6.6 Parameter Setting

Table (4-1)

Prompt Mark	Parameter Setting Items	Code	Parameters
P1	pH buffer solution series selection	<i>SOL</i>	USA (U.S.A series) NIS (NIST series) CH (China series)
P2	Pure water pH temperature compensation setting	<i>PU 1</i>	OFF-On (shut-set)
P3	Ammonia added pure water pH temperature compensation setting	<i>PU 2</i>	OFF-On (shut-set)
P4	Temperature unit setting		°C - °F
P5	Backlight display time setting	<i>BL</i>	0-1-3-6min
P6	Auto power off setting	<i>AC</i>	0-10-20min
P7	Restore to producer setting		OFF-On

### 6.6.1 pH buffer solution series selection (P1)

(a) Long press **MODE**, meter enters P1 mode: see picture (4-2).

(b) Press **CAL** or **M+ / RM** to choose buffer solution series:

(U.S.A series) — 1.68, 4.00, 7.00, 10.01 and 12.45 pH

(NIST series) — 1.68, 4.01, 6.86, 9.18 and 12.45 pH

(China series) — 1.68, 4.00, 6.86, 9.18 and 12.46 pH

(c) Press **MODE** to enter next parameter setting or press **ENTER** to confirm and return to measurement mode.

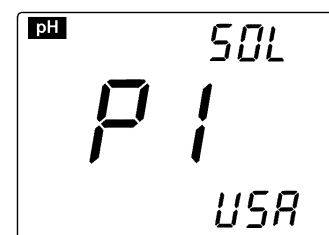

Picture (4-2)

### 6.6.2 Pure water pH temperature compensation setting (P2)

- (a) Short press **MODE** in P1, the meter enters mode P2, see picture (4-3).
- (b) Press **CAL** or **M+RM** to choose *On* (pure water pH temperature compensation setting) or *OFF*
- (c) Press **MODE** to enter next parameter setting or press **ENTER** to confirm and return to measurement mode.
- (d) The factory default setting is OFF

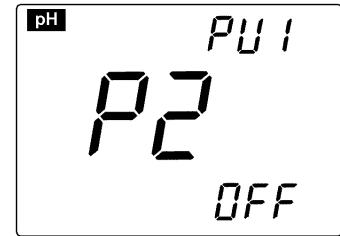

Picture (4-3)

Note: *PU1* will appear in the upper right corner of the LCD if pure water temperature compensation function is set.

### 6.6.3 Ammonia added pure water pH temperature compensation setting (P3)

- (a) Short press **MODE** in mode P2 to enter mode P3, see picture (4-4).
- (b) Press **CAL** or **M+RM** to choose *On* (ammonia added pure water pH temperature compensation setting) or *OFF*
- (c) Press **MODE** to enter next parameter setting or press **ENTER** to confirm and return to measurement mode.
- (d) The factory default setting is OFF

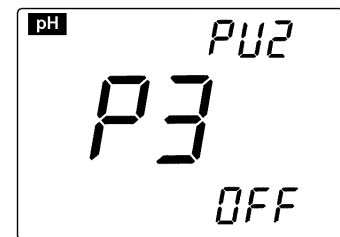

Picture (4-4)

Note: If the ammonia pure water pH temperature compensation function is set, *PU2* will appear in the right upper corner of the LCD when in measurement mode.

### 6.6.4 Temperature unit °C/°F setting (P4)

- (a) Short press **MODE** in P3 to enter P4, see picture (4-5).
- (b) Press **CAL** or **M+RM** to choose temperature unit: °C or °F.
- (c) Press **MODE** to enter next parameter setting or press **ENTER** to confirm and return to measurement mode.

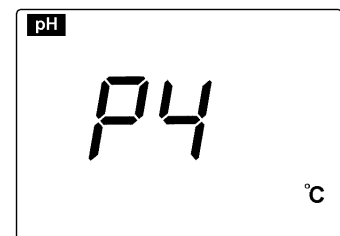

Picture (4-5)

### 6.6.5 Backlight display time setting (P5)

- (a) Short press **MODE** in P4 to enter P5, see picture (4-6).
- (b) Press **CAL** or **M+RM** to choose the time of backlight auto off: 0 min, 1 min, 3 min or 6 min. The backlight will be closed if choosing 0 min.
- (c) Press **MODE** to enter next parameter setting or press **ENTER** to confirm and return to measurement mode.
- (d) The factory default setting for P5 is 1min.

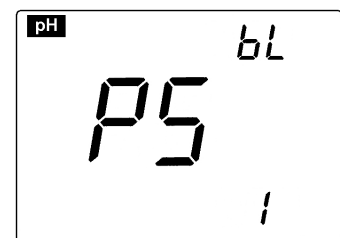

Picture (4-6)

### 6.6.6 Auto power off time setting (P6)

- (a) Short press **MODE** in P5 to enter P6, see picture (4-7).
- (b) Press **CAL** or **M+RM** to choose the time: 0min, 10min or 20min. The auto power off function will be closed if choosing 0min.
- (c) Press **MODE** to enter next parameter setting or press **ENTER** to confirm and return to measurement mode.
- (d) The factory default setting for P6 is 10min.

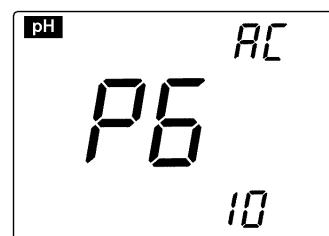

Picture (4-7)

### 6.6.7 Restore to factory default setting (P7)

- (a) Short press **MODE** in P6 to enter P7, see picture (4-8).
- (b) Press **CAL** or **M+RM** to choose **On**, meaning that the parameters have been restored to the producer setting mode, and return to measurement mode after 2 seconds. Returning to factory default setting is to restore the meter to theoretical value (zero potential pH is 7.00, slope is 100%), and set all the parameters to default settings. When the meter's calibration or measurement is performing abnormally, users can use this function, and then calibrate and test again. Please note that this function is irreversible once used.

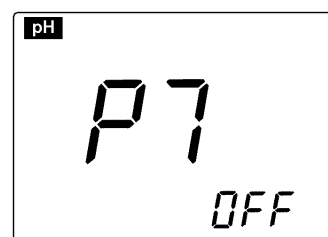

Picture (4-8)

## 6.7 Cleaning pH Electrode

- 1) The measurement is only as accurate as the electrode is clean. Always thoroughly rinse off the electrode before and after each test with pure water. Use soap water if necessary.
- 2) For tough contaminants, soak the electrode in Apera electrode cleaning solution (AI1166) for at least minutes. Then use a soft brush to remove the contaminants. Afterwards, soak the electrode in 3M KCL soaking solution for at least 2 hours. Rinse it off, then re-calibrate the tester before using again.

## 6.8 The Self-diagnose Information

During usage, the following icons may show up on LCD. This is the meter's self-diagnose information, which can help you understand what may go wrong with the meter or electrode.

6.8.1. The stable icon **-2.00 pH** or **19.99 pH** — this icon appears when the pH value exceeds the measurement range. This icon will also show up when the electrode is not well connected with the meter or when the electrode is not inserted into solution. This is a normal phenomenon.

6.8.2. *Err 1*— Electrode offset out of range (<-60mV or >60mV)

6.8.3. *Err 2*— Electrode slope out of range (< 85% or >105%)

When *Err 1* or *Err 2* shows up:

- 1) Make sure there is no damage on the electrode's glass bulb (if so, an electrode replacement is necessary). Check if there is air bubble inside the glass bulb. If so, shake the electrode with force for several seconds to remove the bubble.
- 2) Check the quality of buffer solution. Make sure it's fresh and clean and conforms to the meter's buffer series setting.
- 3) Set the meter to factory default setting mode (refer to section 6.6.7), then recalibrate it.

If the meter is still not working after the above checkings, it's time to replace a new pH electrode or contact us at +1 (614) 285-3080 or [info@aperainst.com](mailto:info@aperainst.com) for help.

## 6.9 Notes about pH

- 1) Never store pH electrode in pure water as it will damage the electrode. Always store the electrode in 3M KCL soaking solution (AI1107).
- 2) If you find any air bubble in the glass bulb of the pH sensor, simply shake the probe with force for a few times to remove it. The existence of an air bubble in the glass bulb will significantly decrease the stableness of measurement.
- 3) pH electrode is technically a chemical battery. Every pH electrode will eventually die even if you don't use it at all. The typical service life of a pH electrode is 1-2 years depending on how you use and maintain it. We recommend replacing your pH electrode after one year of use to ensure the best result.
- 4) Always keep the meter's connector clean and dry, otherwise it may lead to an inaccurate measurement. If contaminated, clean the connector with alcohol prep pads and blow-dry.

---

---

## 7 Conductivity Measurement



---

---

### 7.1 Preparation



Press  to power on, connect the 2301T-S conductivity electrode (See Section 5 for connection tutorial); the meter will automatically change to conductivity measurement mode.

## 7.2 Conductivity Calibration:

8.2.1 Short press  to enter calibration mode, **CAL** flickers on LCD, indicating the meter enters calibration mode. Rinse off the electrode in pure water and remove excess water, then insert it into the 1413µS standard solution, make a quick stir and then hold it still. When the reading is stabilized and stays on screen, short press  again to finish calibration. **1413 µS** will start flickering and then a flickering **End** will show up, and the meter will return to measurement mode.  shows up at the lower left corner, indicating a successful conductivity calibration. If the measurement is not stable, you can perform the calibration once again.

**Note:** Conductivity can only be calibrated under the mode of conductivity. If in other modes, please switch back to conductivity before pressing .

## 7.3 Sample Test

Screw off the storage bottle. Rinse the electrode with pure water. Shake off excess water or blot-dry with clean tissue or kimwipe. Stir the electrode for a few seconds after it's dipped into the sample solution and then hold it still. Wait for the reading to get fully stabilized (  appears and stays). Then save the measurement by pressing .

Hold  to switch measurement unit:

**TDS** (TDS) → **SAL** (Salinity) → **RES** (Resistivity) → **COND** (Conductivity).

Release the button when you make a selection.

## 7.4 Conductivity Electrode's Maintenance

- 1) Always keep the conductivity electrode clean. Before taking a measurement, rinse the electrode in pure water. It is recommended to rinse it again in the sample solution. When submerging the electrode in solution, stir the solution briefly to eliminate air bubbles and allow it to stay until a stable reading is reached. When not in use, store the conductivity electrode in pure water.
- 2) The sensor of 2301T-S conductivity electrode is coated with platinum black to minimize electrode polarization and expand measuring range. The platinum black coating adopted our special processing technology, which improves the electrode performance and the firmness of the coating. If the platinum black electrode is stained, gently clean the electrode with soft brush in warm water containing detergent or alcohol.

## 7.5 Notes about Conductivity Calibration

- 1) This meter has a unique one-point calibration function, to choose the standard calibration solution that's close to your sample's conductivity. In general, the most common calibration solution is 1413  $\mu\text{S}/\text{cm}$ . Use the equipped 2301T-S conductivity electrode ( $K = 1.0$ ). Please choose the calibration solution according to the Table (6-1).
- 2) The conductivity electrode has been calibrated before meter leaving factory. In general, user can directly use it.
- 3) We recommend calibrating the electrode once every month. It is necessary to perform calibration when replacing a new conductivity electrode.

Table (6-1)

Electrode Model	DJS-0.1-S	2301T-S		
Measurement range	0.05 to 20 $\mu\text{S}/\text{cm}$	0.5 $\mu\text{S}/\text{cm}$ to 200mS/cm		
Electrode constant	K=0.1 (flow test)	K=1.0		
Calibration solution	84 $\mu\text{S}/\text{cm}$	84 $\mu\text{S}/\text{cm}$	1413 $\mu\text{S}/\text{cm}$	12.88 mS/cm 111.9 mS/cm
Calibration icon	Ⓕ	Ⓕ	Ⓜ	Ⓜ

## 7.6 Parameter Setting:

Conductivity measurement parameter setting Table

Table (6-3)

Prompt Mark	Parameter Setting Items	Code	Parameter
P1	Standard solution series selection	SOL	USA (84 $\mu\text{S}/\text{cm}$ , 1413 $\mu\text{S}/\text{cm}$ , 12.88 mS/cm, 111.9 mS/cm) CH (146.6 $\mu\text{S}/\text{cm}$ , 1408 $\mu\text{S}/\text{cm}$ , 12.85mS/cm, 111.3mS/cm)
P2	Electrode constant selection	Con	0.1, 1, 10
P3	Reference temperature selection	REF	25°C 20°C 18°C
P4	Temperature compensation coefficient setting	tCC	0.00 to 9.99%
P5	Electrode constant setting	CC	
P6	Temperature unit setting		°C / °F
P7	Backlight display time setting	BL	0-1-3-6min
P8	Auto power off time setting	AC	0-10-20min
P9	Restore to producer setting		OFF-On

### 7.6.1 Conductivity calibration solution series selection (P1)

(a) Press **MODE**, meter enters P1 mode, see picture (6-3);

(b) Press **CAL** or **M+/RM** to choose the standard solution series:

**USA** —U.S.A. series      **CH** — China series

(c) Press **MODE** to enter the next parameter setting or press **ENTER** to return to measurement mode.

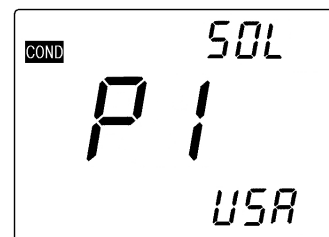

Picture (6-3)

### 7.6.2 Electrode constant selection (P2)

(a) In P1, short press **MODE** to enter P2 mode, see picture (6-4);

(b) Press **CAL** or **M+/RM** to change the constant setting: 0.1→1.0→10.0.

(c) Press **MODE** to enter the next parameter setting or press **ENTER** to return to measurement mode.

(d) The factory default setting of P2 is K=1.0.

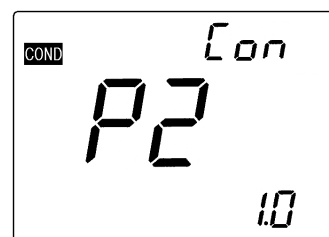

Picture (6-4)

### 7.6.3 Reference temperature selection (P3)

(a) In P2, short press **MODE** to enter P3, see picture (6-5);

(b) Press **CAL** or **M+/RM** to choose 25°C→20°C→18°C;

(c) Press **MODE** to enter the next parameter setting or press **ENTER** to return to measurement mode.

(d) The factory default setting of P3 is 25°C.

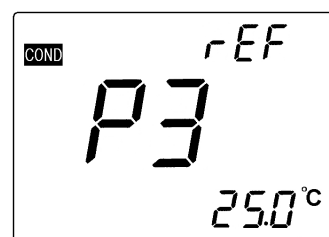

Picture (6-5)

### 7.6.4 Temperature compensation coefficient setting (P4)

(a) In P3, short press **MODE** to enter P4, as shown in picture (6-6);

(b) Press **CAL** or **M+/RM** to change the number, the changing range of data is from 0.00 to 9.99; long press **CAL** or **M+/RM** to change quickly.

Attention: When the number set as 0.00, means there is no temperature compensation, for details please see Section 7.7;

(c) Press **MODE** to enter the next parameter setting or press **ENTER** to return to measurement mode.

(d) The producer setting of P4 is 2.00%.

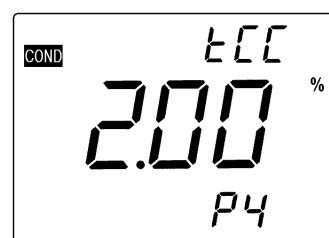

Picture (6-6)

### **7.6.5 Constant calibration setting (P5), please refer to Section 8.5.**

(a) In P4, short press **MODE** to enter P5, LCD display last calibration constant. For example, 0.96cm<sup>-1</sup> shown as picture (6-7);

(b) Press **CAL** or **M+  
RM** to change number when the number is flickering, and finish setting the constant which marked on the housing of conductivity electrode.

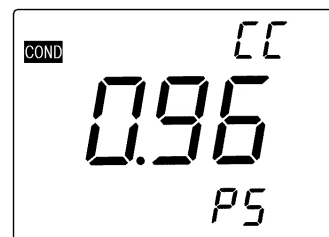

Picture (6-7)

(c) Press **MODE** to enter the next parameter setting or press **ENTER** to return to measurement mode.

(d) If you need to do calibration for other conductivity electrode whose constant is not 1.0, e.g. conductivity electrode with constant 10.3, you should enter constant setting P2 to set the constant to be “10”, then enter P5 mode and set the constant to be 10.3.

### **7.6.6 Temperature units °C/°F selection (P6)**

In P5, short press **MODE** and enter P6, for details please refer to Section 6.6.4.

### **7.6.7 Backlight display time setting (P7)**

In P6, short press **MODE** and enter P7, for details please refer to Section 6.6.5

### **7.6.8 Auto power off time setting (P8)**

In P7, short press **MODE** and enter P8, for details please refer to Section 6.6.6

### **7.6.9 Restore to producer setting (P9)**

In P8, short press **MODE** and enter P9, for details please refer to Section 6.6.7

## **7.7 Temperature compensation coefficient**

The temperature compensation coefficient of the meter setting is 2.0%/°C. However, the conductivity temperature coefficient is different from solutions and concentration. Please refer to Table – 11 and the data collected during testing. Do the setting in P4. (see Section 7.6.4 for more).

Note: When the coefficient for the temperature compensation is set to 0.00 (no compensation), the measurement value will be based on the current temperature.

Table-11 Temperature compensation coefficient of special solutions

Solution	Temperature compensation coefficient
NaCl solution	2.12%/°C
5% NaOH solution	1.72%/°C
Dilute ammonia solution	1.88%/°C
10% hydrochloric acid solution	1.32%/°C
5% sulfuric acid solution	0.96%/°C

## 7.8 Notes about conductivity parameter setting

When the content of conductivity parameter setting is different to the factory default setting, the correspondent code icon will appear on the upper right of LCD in measurement mode. When more than one conductivity parameter is changed, only one code will be displayed. You need to enter the parameter setting and check the settings content or restore the meter to factory default setting and set the needed parameters again.

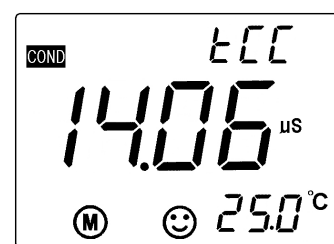

Picture (6-2)

## 8 Replacement Parts and Accessories

### **⚠ WARNING**



Use of non-approved parts may cause damage to the instrument or equipment malfunction. The replacement parts in this section are approved by the manufacturer.

#### Replacement Parts

Description	SKU	Quantity
201T-S ATC pH electrode	AI1312	1 pc
2301T-S Plastic Conductivity Electrode	AI1313	1 pc
pH buffer solution kit	AI1115	8 oz. each
pH buffer solution kit with CalPod Solution Organizer	AI1116	16 oz. each
1413 $\mu$ S/cm Conductivity Standard Calibration Solution	AI1130	4/8/16 oz.
3M KCl Electrode Storage Solution	AI1107	8 oz.
Electrode Protective Cap	AIX201	1 pc
Electrode Storage Vial	AI2511	3 pcs

#### Accessories

Description	SKU	Quantity
DJS-0.1-S Low-range Conductivity Electrode	AI1318	1 pc
600 Simple Electrode Holder	AI2813	1 pc
Electrode Cleaning Solution	AI1166	8 oz.
301Pt-S ORP Electrode	AI1315	1 pc
pH/Conductivity Calibration Solution Kit	AI1112	1 pc
pH Electrode Maintenance Kit	AI1170	1 pc
8-pin to BNC/RCA Converter	AI7103	1 pc

For pH electrodes for special applications, refer to Section 6.5

---

---

## **9 Limited Warranty**

---

---

We warrant this instrument to be free from defects in material and workmanship and agree to repair or replace free of charge, at option of APERA INSTRUMENTS, LLC, any malfunctioned or damaged product attributable to responsibility of APERA INSTRUMENTS, LLC for a period of THREE YEARS (SIX MONTHS for the electrodes) from the delivery.

This limited warranty does not cover any damages due to:

Transportation, storage, improper use, failure to follow the product instructions or to perform any preventive maintenance, modifications, combination or use with any products, materials, processes, systems or other matter not provided or authorized in writing by us, unauthorized repair, normal wear and tear, or external causes such as accidents, abuse, or other actions or events beyond our reasonable control.

**APERA INSTRUMENTS, LLC (USA)**

Address: 6540 Singletree Dr, Columbus OH 43229

Tel: +1 (614) 285 3080

Email: [info@aperainst.com](mailto:info@aperainst.com)

Website: [aperainst.com](http://aperainst.com)